

THE MOST BEAUTIFUL MOST USEFUL MODERN HOMES MAGAZINE

ELLE DECORATION

**DONNA
KARAN'S
TIPS FOR
SENSUAL
LIVING**

FEBRUARY 2002 £3.00

**UK
EDITION**

**BABY,
IT'S WARM
INSIDE ...**

**THE NEW WAY TO
DO A DINNER PARTY**

**24 PAGE
BATHROOM
SPECIAL
NEW LOOKS
HOT TRENDS
30 BEST BUYS**

69 SNUG IDEAS

**DUSKY PINK MOHAIR, CREAMY WHITE SHEEPSKIN,
CAFE LATTE LAMBSWOOL & DIP-DYED LACE**

SUNLIT HOMES TO BANISH THE WINTER BLUES



US \$6.95 PRINTED IN THE UK



BATHING BEAUTIES

Rethink your bathroom with the help of DECO's three experts: Marcia Kilgore of new London spa Bliss; Robert Calcraft of über-cool cosmetics company Ren; and Julian Vogel of Modus Publicity, whose clients include Elemis, Sundāri and MAC
By Claire Bingham
Styling Finola Inger
Photography Mel Yates and Hugh Stewart

BLISSFUL BATHING MARCIA KILGORE

Marcia Kilgore (below) is the woman behind New York's hugely successful Bliss Spa and she's just opened her first UK spa in London. Having soothed stressed-out Statesiders for the last five years, she knows exactly what's needed for a calming bathroom. Her own, in her penthouse flat in Brooklyn, is compact with a sunken bath. 'I don't like anything ornate,' she says. 'My style is simple.' Her advice for enjoying bath time? 'Always have a glass of wine,' she says. 'I usually light a candle and put a towel behind my neck so I can relax.' Bliss. *Treatments at Bliss London cost from £23 for a manicure (020 7584 3888; www.blissworld.com).*



SUNKEN BATH

Marcia's polished concrete bath (see main picture) with built-in whirlpool jets was a bespoke installation, made by a New York company. For something similar, try cement supremos Totem Design, who can cast a similar tub to commission (expect to pay anything from £6,000 upwards).

In theory, any bath can be transformed into a sunken design by raising the surrounding floor. Of course, this is a major task, and you need to be sure your ceiling is sufficiently high that you'll be able to stand up straight on the newly raised floor.

If you want to completely overhaul your room, contemporary bathroom design company Bathaus can visit your home and draw up plans.



VERSATILE WINDOW

Marcia's window changes from opaque to transparent at the flick of a switch (see left and below left). It's made from a product called SGG Priva-lite, which has a film of liquid crystal molecules between two sheets of glass. When a current passes through them, the molecules scatter, turning the glass opaque; when switched off, they line up and the panel is clear. Contact Solaglass for a quote (installations cost from £1,500 per sq m).

For a permanent frosted look, install acid-etched glass, from good glaziers; or buy acid-etch spray, £3.29 per 150ml, at Focus, and frost the window yourself. >

PHOTOGRAPHER: HUGH STEWART (MARCIA KILGORE BATHROOM PICTURES)

B L I S S F U L B A T H I N G

Where and what to get to have the look of Marcia's chilled-out New York bathroom:

- An alternative to a poured concrete bath, like Marcia's, is to use either **Corian** (see page 14 for more details) or the similar polyester-based solid-surface material **Durat**. Joins where the floor and tub meet can be sanded down for a seamless look.
- German company Sprinz makes a good selection of **frameless glass shower enclosures**, available at Bath And Glassworks.
- Marcia's shower has a mosaic-tiled wall and two shower heads (see below). For similar wide, old-fashioned **shower roses**, try West One Bathrooms; for tiles, try **'Glacial' glass tiles** in an ice or frost finish, £5.99 each for a 10cm sq size, from Smith & Wareham.
- The bath surround in Marcia's bathroom incorporates a **flexible-hose hand shower** (see main picture, previous page) which pulls out, then fits neatly back into the surround when not in use. Try Aston Matthews for a similar design, from £35.
- To keep the look light and uncluttered, install **glass shelves** made from 8mm-thick toughened glass supported on chrome brackets, both available from DIY stores.



WALL-MOUNTED RADIATOR
ABOVE LEFT: flat-panelled radiator with chrome pegs, from a selection, Bisque. Medium linen towel, from £23, Acca Kappa.

CERAMIC BOWLS
ABOVE CENTRE: from left: 'Circle' faience goblet, £6.95, Aria. Ceramic bowls, small 'D11', from £11; large 'D14', from £16, both Bosa Ceramiche.

ACCESSORIES
ABOVE RIGHT: On bottom shelf: ribbed hand towel, £7.95, The White Company. On middle shelf: 'Classic' bath towel, £13, The White Company. Bath sheet, £17.99, Next Home.



'Bianco' hairbrush, from £11.50, Acca Kappa. Small 'Tarpaulin' wash bag, £3.95, Muji. On top shelf: frosted flip-top bottle, £1.95; frosted pump bottle, £2.75; large 'Tarpaulin' wash bag, £3.95, all Muji. In bag: eucalyptus toothpaste, from £1.70, Acca Kappa. 'Soulful' bath oil, £15, and eau de toilette spray, £29, both Space NK.

SUNKEN BATH
OPPOSITE: for a similar bath, try the 'Centroform' bath by Kaldewei, £970, from Scobles. Chrome and frosted glass trolley (27 W



x 80 H x 46cm D), £340, Samuel Heath & Sons. On bath surround, from top: bath sheet, £29.50, Designers Guild. Linen towels, small, from £16.80, and large, from £49.50, Acca Kappa. Ribbed towelling bath mat, £8, The White Company. On trolley: bottom shelf: bath towel, £39.95, Aria. Ribbed hand towel, as before. On middle shelf: 'Classic' bath sheet, £19.50, The White Company. Hand towel, £6.99; bath towel, £12.99, both Next Home. On top shelf: silver mesh wash bag, £10, Heal's. On glass shelf: wash bag and toiletries, stylist's own.



For stockist information, turn to page 134.

Create a calming home spa with clean lines, seamless finishes and soft, white towels

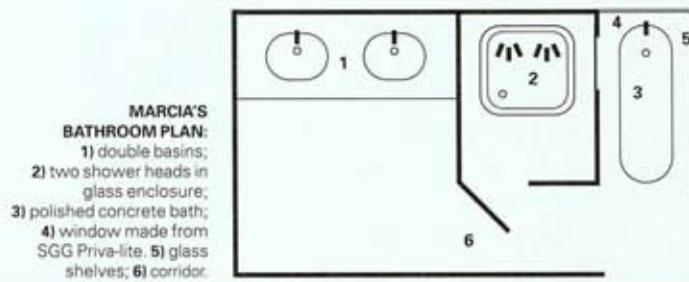

THIS PICTURE:
M3 Architects (020 7729 4222), designed this London bathroom, which, like Marcia's, has a sunken bath (see opposite for details).